

KEY:

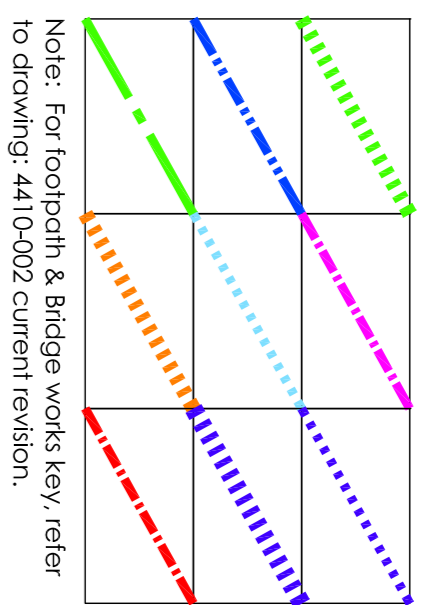

Note: For footpaths & Bridge works key, refer to drawing: 4410-002 current revision.

Stone dust path with timber sleepers to form steps on steep path section. Include a tubular galvanised steel handrail.

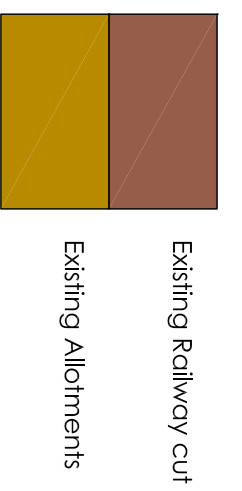
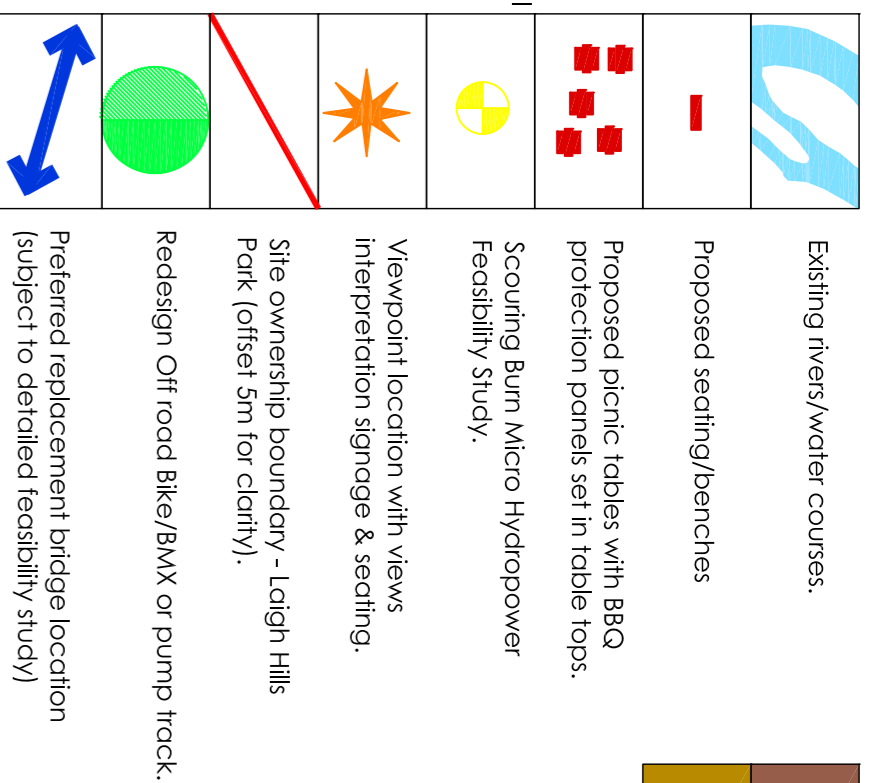
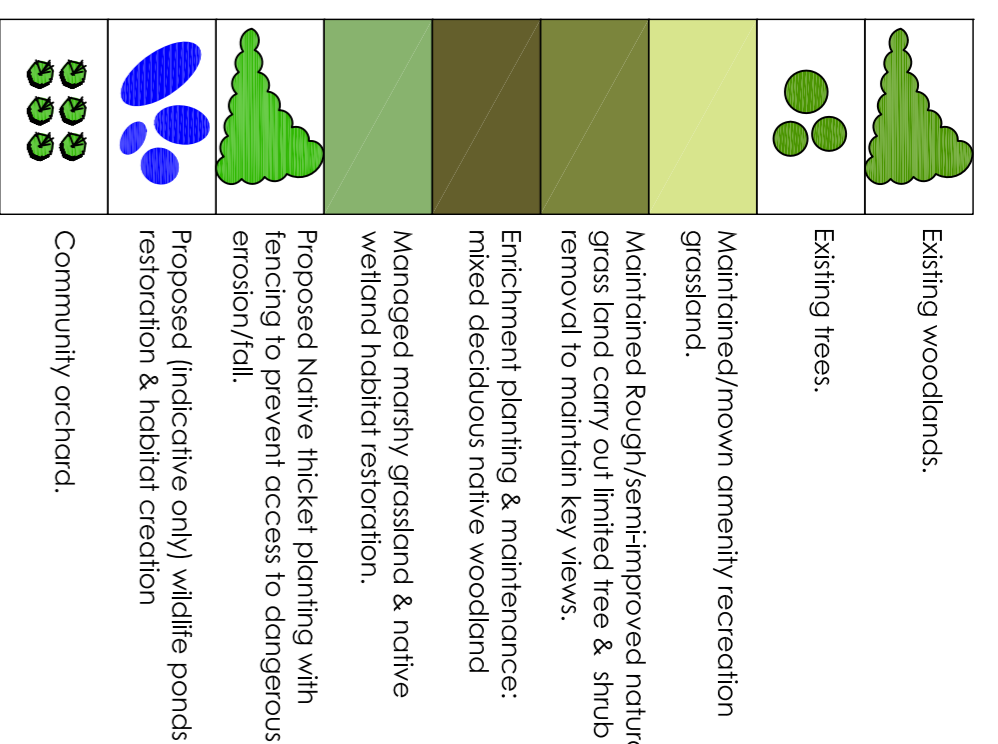
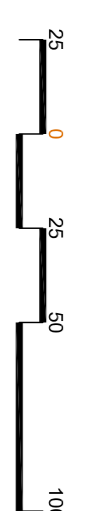

Note: This plan is the physical spatial layout only. Other management and use proposals are set out within the strategic landscape masterplan report & associated park design guide. Detailed management & maintenance reports are a key recommendation of this process - see Masterplan Proposal in the masterplan report.

Management of all habitats and amenity areas should maximise the potential for key long distance views from the highlighted viewpoint location. Management & maintenance should also protect existing short views into and out for the site around the existing recreation area.

There is an ongoing Giant Hogweed eradication program which is currently being carried out using local volunteers for the Lough Hills Park area in partnership with Forth Fisheries. This may benefit from further detail mapping of outbreeds throughout the Lough Hills park extents.

For strategic landscape masterplan paths and civil engineering proposals please also see drawing layout 4410-002 current revision.

All proposed park furniture or signage should be fully in accordance with the Park Design Guide section of the full masterplan report.

All paths & civil engineering works which are recommended within this strategic landscape Masterplan must be fully in accordance with Mullard Consulting's Report on the Strategic Landscape Masterplan (2012) for Lough Hills Park RFP-12707/DK17198 Rev. 4.0. To note that there are some additional paths recommended within the Strategic Landscape Masterplan which superseded the above report.

This Masterplan layout is Strategic only and not for construction - any construction works should be carried out from detailed design layouts only.

BS 3837:2012 - Trees in relation to demolition, design & construction must be adhered to, on a project by project basis, where there are likely to be direct impacts on either individual trees or groups of trees/woodlands. This must include any movement of vehicles to, or through the site for construction & management/maintenance. It must also include any, or all, exercises which take place as a consequence of each particular detail design project.

Additional topographical, ecological, hydrological and wetland surveys should be carried out on a project by project basis limited to the extent of the physical works being carried out.

Detail design projects must take into account all the information provided in the technical appendix which supports the Park's Strategic Landscape Masterplan.

DRAFT

REVISIONS:

| NO. | DATE |
|------------------------------------------------|----------|
| A | 18-03-14 |
| Adjustments further to Steering Group comments | |

Canon Design
Landscape Architects + Urban Designers

Unit 21
59 Main Street
The Village
G67 2R
Tel: 01236 780660
info@canondesign.co.uk
www.canondesign.co.uk

CLIENT:
STIRLING COUNCIL

PROJECT:
LAUGH HILLS PARK STRATEGIC
LANDSCAPE MASTERPLAN

STATUS:
INFORMATION

DRAWING TITLE:
PARK MASTERPLAN

DRAWING NUMBER:
4410.001 - Rev. A

REVISION:
SCALE: From Dcr
SHEET: A1

DATE: 08.01.14
DRAWN: jdc
CHECKED: BC

Detailed biological and hydrological assessment study required in order to advise on the potential for ponds and watercourse habitat improvements linked with improved amenity value full extent of Scouring Burn through improved park gateway/entrance design.

Finger signage required on Kenyon opposite Lough Hill Loan entrance. This signage must attach to the existing street lighting column.

Improved gateway: Parking restrictions should be considered to enhance entrance to the park. Key physical accessibility and visual legibility.

Proposed Community led Park Pavilion & Toilets project. All capital and maintenance funding to be the responsibility of Dunblane Development Trust.

Sports Pavilion - Stirling Council to continue to maintain the fabric of the building in accordance with current delegations/maintenance responsibilities (Dunblane Soccer Club) to continue to maintain the interior of the Pavilion in accordance with the current lease agreement.

Dedicated disabled parking spaces provision on West side of the Allion Marder from main roads & settlement centre.